

TORNADO

Model
FP-450T



Thanks for Choosing Tornado
Food Processor

ELARABY



19319

www.elarabygroup.com



Tornado

Important Safety Instructions

Before using the electrical appliance, the following basic precautions should always be followed including the following:

1. Read all instructions, and save it for future reference.
2. Before using, check that the voltage of wall outlet corresponds to that shown on the rating plate.
3. Do not operate any appliance with a damaged cord or plug or after the appliance malfunctions, or is dropped or damaged in any manner. Bring it to a qualified technician for examination, repair or electrical or mechanical adjustment.
4. Do not let cord hang over edge of table or counter.
5. To protect against risk of electrical shock, do not put the motor base into water or other liquid. To disconnect, turn any control to "off", then remove plug from wall outlet by grasping the plug, not the cord.
6. This appliance is not intended for use by persons (including children) with reduced physical, sensory or mental capabilities, or lack of experience and knowledge, unless they have been given supervision or instruction concerning use of the appliances by a person responsible for their safety.
7. Close supervision is necessary when any appliance is used by or near children.
8. Keep hands and utensils away from moving blades or discs while processing food to reduce the risk of severe injury to persons or damage to the Food Processor. A scraper or spatula may be used, but must be used only when the Food Processor is not running.
9. Avoid contacting moving parts.
10. Never feed food by hand. Always use food pusher.
11. Before removing the lid from the jar from the power unit, switch off the unit, wait until the blades have come to a complete stop.
12. Do not use fingers to scrape food away from discharge disc while appliance is operating. Cut type injury may result.
13. Be certain lid is securely locked into place before operating appliance.
14. Always remove the blade assembly before pouring contents from jar.
15. Be sure to switch off the appliance after each use of your food processor. Make sure the motor stops completely before disassembling.
16. Do not put your fingers or other objects into the unit opening while it is in operation. If food becomes lodged in opening, use food pusher or another piece of fruit or vegetable to push it down. When this method is not possible, turn the motor off and disassemble to remove the remaining food.
17. Do not attempt to defeat the cover interlock mechanism.
18. The metal blades and disk is extremely sharp, handle with care. Always hold the blade assembly by the finger grip or stem, away from the cutting edge, both when handling and cleaning.
19. To reduce the risk of injury, never place processing blade or circle blade ass'y on drive shaft without the processing jar locked properly in place.
20. Do not leave this appliance unattended during use.

Important Safety Instructions

21. If this appliance falls or accidentally becomes immersed in water, unplug it immediately. Do not reach into the water! Do not use this appliance after it has fallen into or becomes immersed in water.
22. To reduce the risk of injury to persons or property, never use this appliance in an unstable position.
23. Do not use this appliance for other than its intended use.
24. The use of attachments not recommended or sold by the manufacturer may cause fire electric shock or injury.
25. Do not use outdoors.
26. Unplug from outlet when not in use, before putting on or taking off parts, and before cleaning.
27. Caution: never immerse in water, unplug before inserting or removing parts.
28. CAUTION: DO NOT OPEN LID UNTIL BLADES STOP.
29. Note: This Food Processor is the multipurpose appliance, plastic blade for kneading can creat maximum rating. Other recommended attachments may draw significantly less current.

Know Your Food Processor

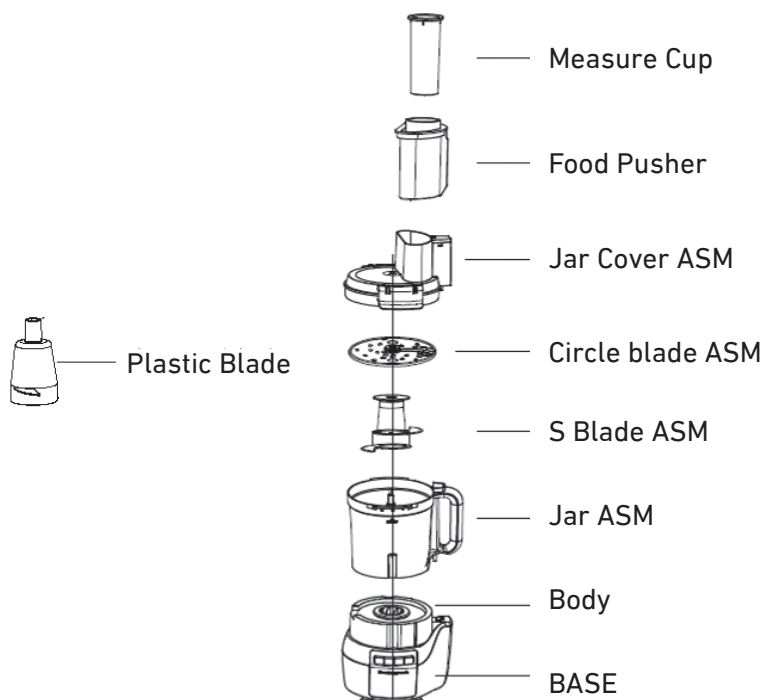

Control Panel



OFF: When you want to stop the appliance during operation or when the machine finishes processing or when the unit is not in use, always press the “OFF” button.

PULSE: Press and hold the button for short or delicate processing tasks. PULSE is used most frequently, as it gives greater control over food processing and fineness.

SLICE/SHRED: low speed, it is suitable for kneading or mixing.

PUREE/MIX: high speed, it is suitable for chopping or slicing/chipping/mix.

Before First Use

Before first use, carefully unpack the food processor and its attachments and remove any package material or label or stickers. Clean all the parts except the motor base following the instructions in **CLEANING AND MAINTENANCE**. Handle the “S” blade or circle blade ass’y with extreme care as they are sharp.

Chopping

1. Firstly assemble the driving shaft into the motor base, make sure it is clipped into position.
2. Place the jar on the motor base and turn it clockwise until it locks into position. Make sure it is assembled in place correctly, otherwise the appliance will not operate.
3. Insert the “S” blade into the driving shaft in the jar securely.
4. Then place the prepared chopping food into the jar. The food must be cut into small size firstly (such as 2cm*2cm*6cm for beef; 2cm*2cm*2cm for cheese; 6cm*2.5cm*120MM for carrots; 2cm*2cm*2cm for celery).. During chopping, you can add food through the feeding funnel with the pusher, never using food or finger to push the food into the feeding funnel.
5. Place the lid onto the jar and turn it clockwise until the tab of the lid clicks into slot in the jar handle. Make sure it is locked in position correctly, otherwise the appliance will not operate.

Chopping

6. Connect the appliance to power supply. Press the corresponding speed button according to your task. You can chop up to 400g of following foodstuff,

Hard substance: cheese, Walnut, carrots, celery

Soft substance: onions

Raw meat :beef(boned and sliced)

CAUTION: The total operating time should not be more than 15 sec.

7. Press the "OFF" button and unplug the appliance after chopping. Grasp blade by its hub and remove. Unlock jar by turning it in anti-clockwise away from its base, and lift it off. Empty the processed food.

CAUTION: The "S" blade is extremely sharp, handle with care.

Cleaning

1. Disconnect the power supply before cleaning.

2. Empty the jar, dismantle all detachable parts and rinse them in warm soapy water. Extreme caution must be taken when handling blade as it is very sharp. All the accessories except motor base are dishwasher safe components, but the temperature setting shall not exceed 70°. Then dry thoroughly.

3. Wipe the outside of base with damp cloth. Never immerse it in water as electric shock is possible to occur. Then dry thoroughly. Ensure the interlock area is free of food particles

FOR A QUICK WASH UP

Between processing tasks, pour in some water into the jar, press and hold the PULSE button for several seconds for quick cleaning.

SLICING/CHIPPING

1. Firstly assemble the driving shaft into the motor base, make sure it is clipped into position.

2. Place the jar on the motor base and turn it clockwise until it locks into position. Make sure it is assembled in place correctly, otherwise the appliance will not operate.

3. Insert the circle blade ass'y into the driving shaft in the jar securely.

Note: if you want to slice, make the surface with slicing blade upward during assemble the circle blade ass'y; if you want to chip, make the surface with chipping hole upward.

4. Place the lid onto the jar and turn it clockwise until the tab of the lid clicks into slot in the jar handle. Make sure it is locked in

Cleaning

position correctly, otherwise the appliance will not operate.

5. Press the corresponding speed button according to your task.

Note: the slicing/chipping blade can slice/chip thickly-potatoes, onions, thinly-cucumbers, boot root, apples, and carrots...

6. Use the pusher to feed food into the feeding funnel. The food shall be cut into proper size to suitable for the feeding funnel (the length of food shall be less than 120mm). You can slice/chip up to 500g of food.

7. The total operating time should not more than 15 sec.

8. Press the "OFF" button and unplug unit after processing.

Remove the circle blade ass'y by its hub Unlock jar by turning it in anti-clockwise away from its base, and lift it off. Empty the processed food.

CAUTION: The circle blade ass'y is extremely sharp, handle with care.

Cleaning

1. Disconnect the power supply before cleaning.

2. Empty the jar, dismantle all detachable parts and rinse them in warm soapy water. Extreme caution must be taken when handling disks as they are very sharp. Then dry thoroughly.

3. Wipe the outside of base with cloth. Never immerse it in water as electric shock is possible to occur. Then dry thoroughly. Ensure the interlock area is free of food particles.

Note: Some food may discolor the circle blade disk. This is normal and will not harm the plastic or affect the flavor of food. Rub with cloth dipped with vegetable oil to remove discoloration.

Environment friendly disposal

You can help protect the environment!

Please remember to respect the local regulations:

hand in the non-working electrical equipments to an appropriate waste disposal center.



ELARABY

 **19319** www.elarabygroup.Com
 Tornado